



TEXAS TECH UNIVERSITY SYSTEM™



Facilities Committee

Michael S. Molina

Vice Chancellor - Facilities Planning & Construction

October 13-14, 2016

Texas Tech University

Item 1

Approve naming of a lab within the Industrial Engineering building

Michael S. Molina

Lisa Calvert



Industrial Engineering Building



Looking Northwest



First Floor Plan

Item 1

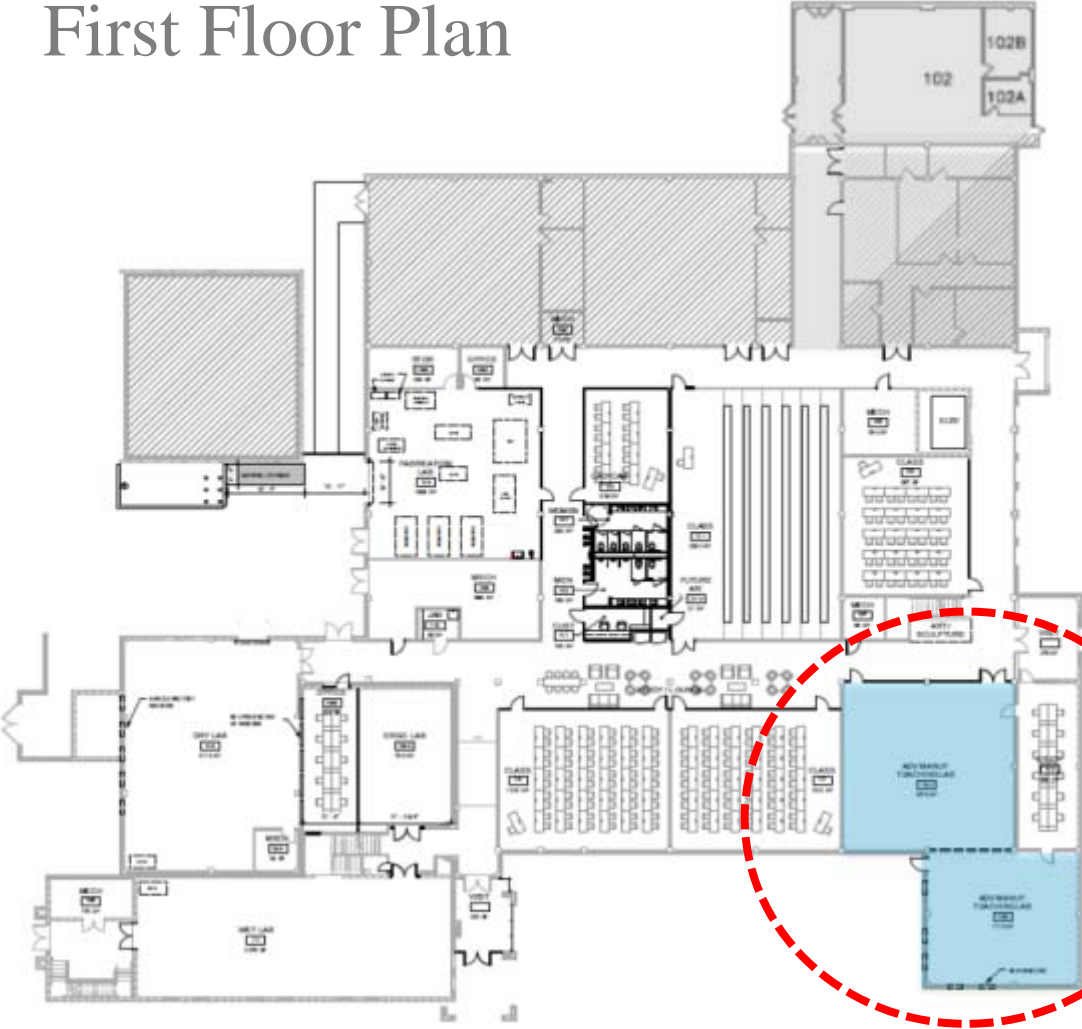

“Stinson Family
Advanced Manufacturing
Technology Laboratory”



Recommendation

Item 1

- Approve naming of the Advanced Manufacturing Technology Teaching Laboratory, a part of the Industrial Engineering building within the Edward E. Whitacre Jr. College of Engineering, to be named the “Stinson Family Advanced Manufacturing Technology Laboratory.”
- The donor concurs with the naming of this interior space. Appropriate signage for the laboratory will specify the approved name.

Texas Tech University

Item 2

Approve naming of the outdoor grass practice field at the Football Training Facility

Michael S. Molina

Lisa Calvert





Sports Performance Center

Football Training Facility

TEXAS TECH
RED RAIDERS

Glenna Goodacre Blvd

University Avenue

“Tim Culp Family Field”



NORTH

Recommendation

Item 2

- Approve naming the outdoor grass practice field at the Football Training Facility, a component of the Edward E. Whitacre Jr. Athletic Complex, the “Tim Culp Family Field.”
- The donor concurs with the naming of the field. Appropriate signage will specify the approved name.

Texas Tech University Health Sciences Center

Item 3

Approve a project to construct the Lubbock Expansion project

Michael S. Molina

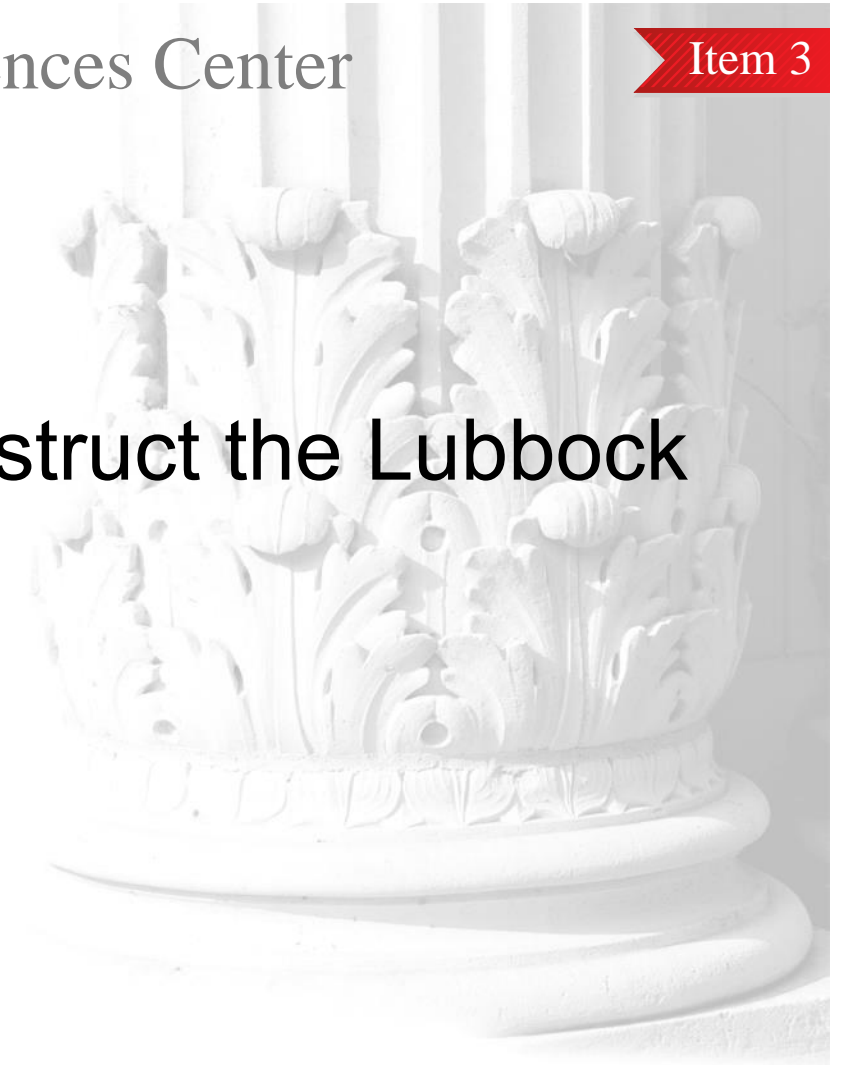

4th Street

5th Street

Texas Tech Parkway

Joliet Avenue

Academic Classroom Building

Medical Pavilion

Preston Smith Library

Texas Tech University Health Sciences Center



NORTH

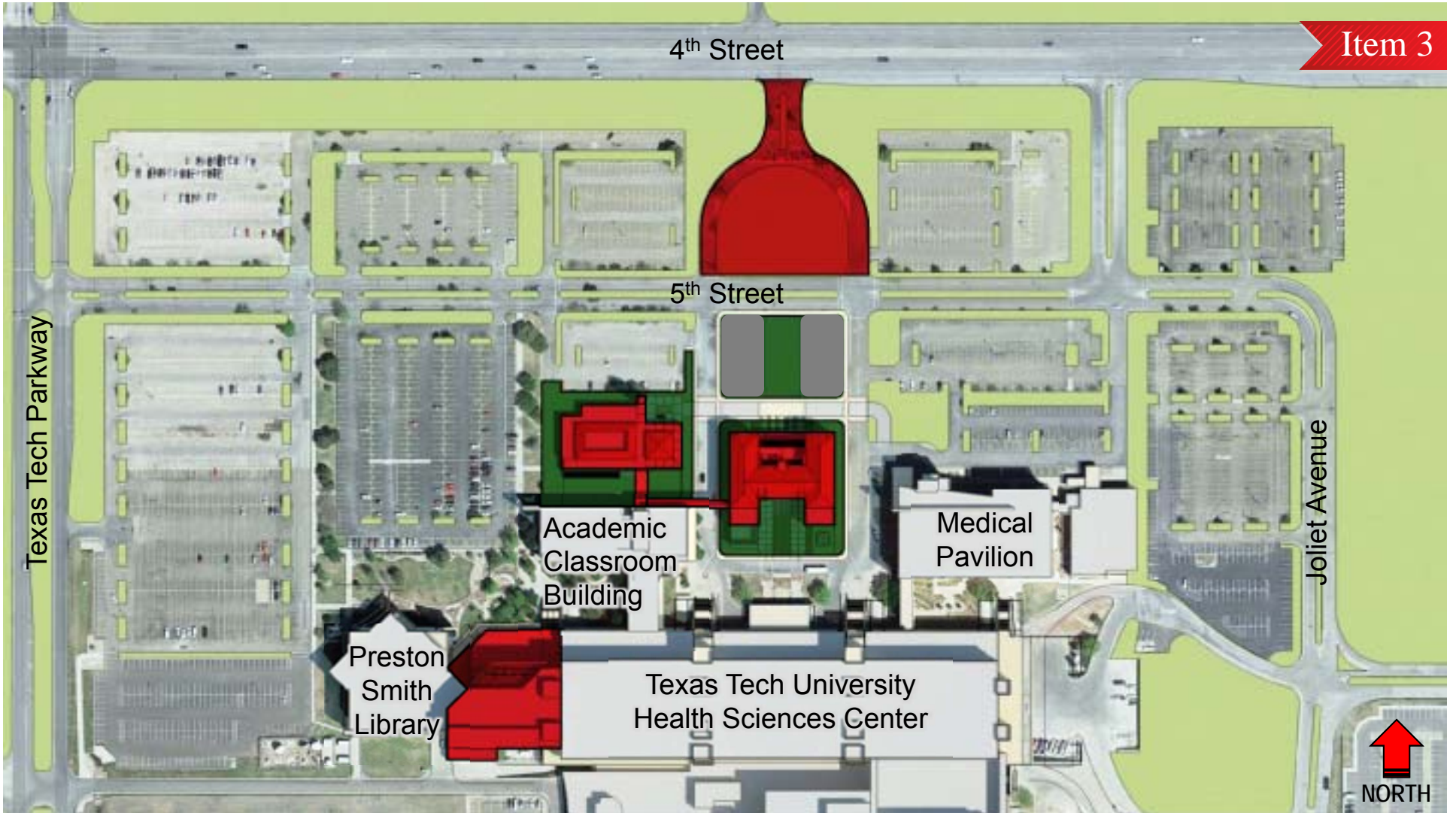

Education, Research and Technology Building

Item 3



Education, Research and Technology Building

Item 3

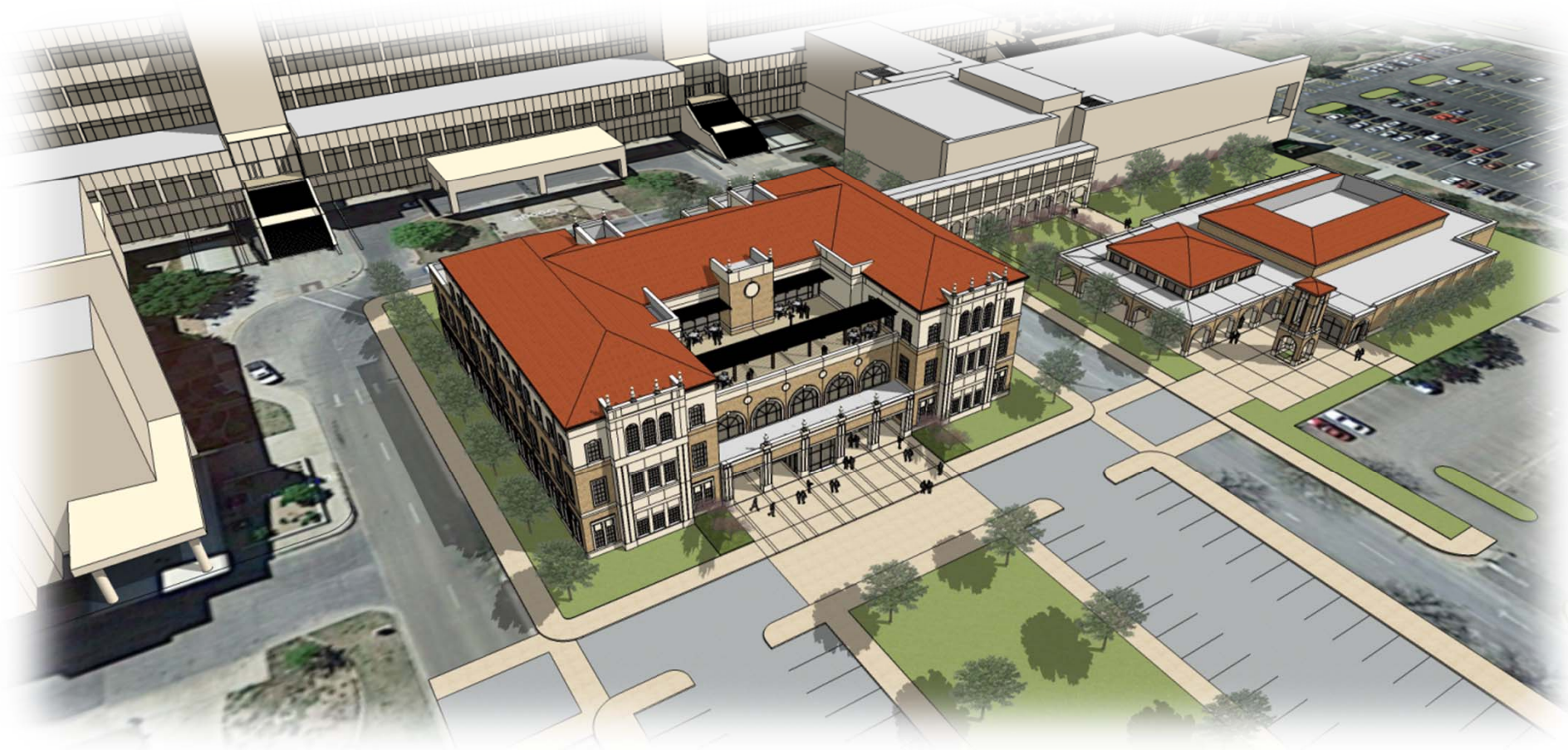

Education, Research and Technology Building

Item 3



Main Entry

Education, Research and Technology Building

Item 3



South Courtyard

West Expansion

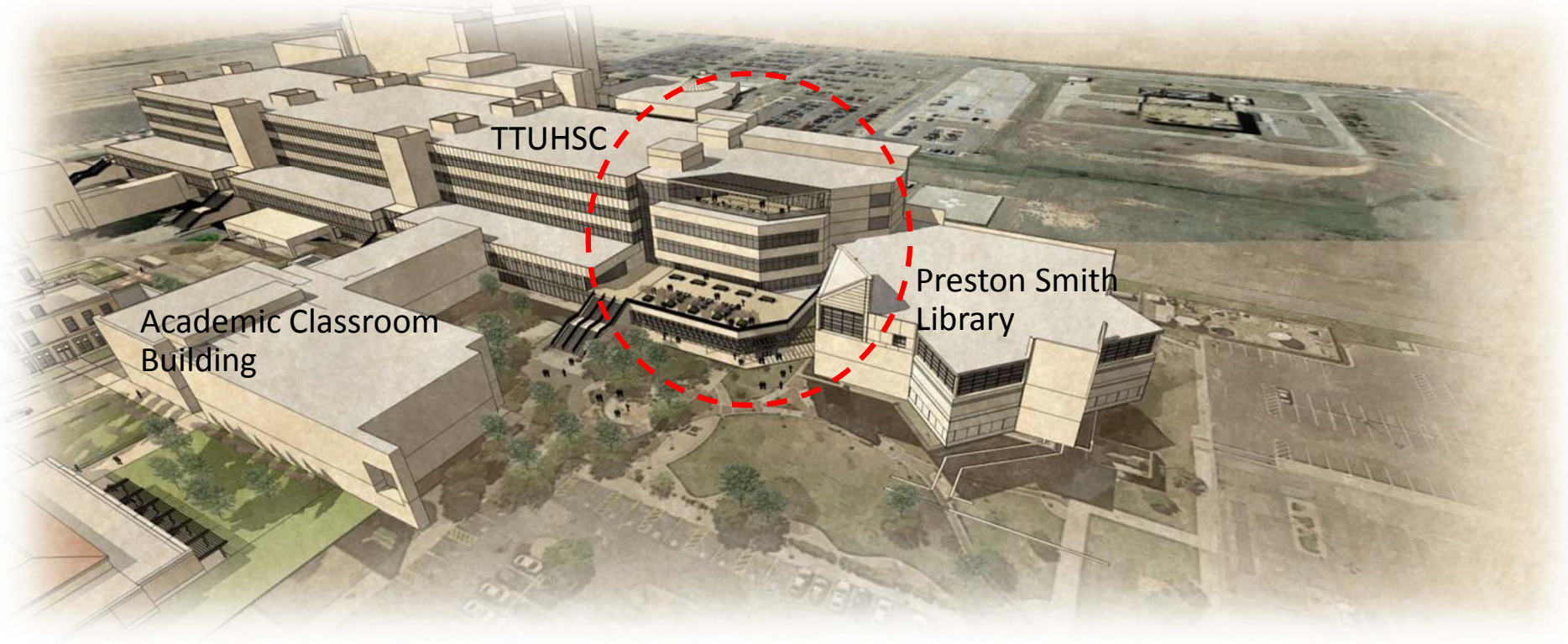

North Elevation Rendering

West Expansion

Item 3



North Elevation Rendering

Project Scope

Item 3

- Construct 3 facilities totaling 183,218 GSF and create a formal boulevard entrance to the TTUHSC campus.
- The West Expansion will construct a 110,576 GSF addition to include:
 - Study and research facilities in anatomical sciences, including a new modern, compliant and larger gross anatomy lab in response to increase School of Medicine class size for LCME Accreditation requirements.
 - Physical connections to Preston Smith Library at the basement and 2nd floor level.
 - 1 - 240 seat flip classroom and 4 - 100 seat classrooms.
 - Student lounge/collaboration study areas.
 - Outdoor terrace areas on 2nd and 5th floors programmed for future growth.
 - Programmed space for potential café kiosk.

Project Scope (cont.)

- The North Expansion will construct the:
 - Education, Research, and Technology building with 58,142 GSF including:
 - State-of-the-art research laboratories,
 - Translational research facilities classrooms,
 - Offices, teaching and support space,
 - New technology and equipment, and
 - Related infrastructure upgrades.
 - Free-standing Conference Center with approximately 14,500 GSF adjacent to the new Education, Research, and Technology building and the existing Academic Classroom Building providing accessibility, connectivity and promoting the use of the facilities by the entire campus community.

Project Scope (cont.)

- New 4th Street Boulevard Entrance to include:
 - Formal entrance to the TTUHSC campus.
 - Additional ingress and egress to the campus at a signalized intersection.
 - Address the campus long-range master plan vision.
- Projects to include site and utility infrastructure work, landscape enhancements, and public art.

Project Budget

Item 3

Total Project Budget **\$ 85,900,000**

Construction	\$ 63,565,131
Professional Services	\$ 9,720,722
FF&E / Other Items	\$ 6,439,009
Administrative Cost	\$ 754,030
<i>Regents' Rules</i>	\$ 3,687,886
(2.4% FP&C / 1% Public Art / 1% Landscape Enhancements)	
Contingency	\$ 1,733,222

Substantial Completion: January 2019

Recommendation

- Authorize to proceed with a project to plan, design, and construct the new Education, Research & Technology building, the Conference Center building, TTUHSC's West Expansion, and new front entry to the Lubbock TTUHSC campus with a total project budget of \$85,900,000; report the project to the Texas Higher Education Coordinating Board; amend the Design Professional contract; amend the Construction Manager Agent contract; and amend the Construction Manager at Risk contract.
- The project budget of \$85,900,000 is comprised of the Revenue Finance System ("RFS") funding of the 84th Texas Legislature's Regular Session authorization of Tuition Revenue Bond ("TRB") (\$60,264,000), and Unexpended Plant Funds Cash (\$25,636,000).
- The budget includes the previous approved Stage I design budget of \$2,403,613 which was funded through RFS repaid with the TRB Legislative appropriation.

Texas Tech University System

Item 4

Report on Facilities Planning and Construction projects (project data as of 09/28/16)

Michael S. Molina



TTU – Experimental Sciences Building II

Project Budget: Original / Current
 \$ 77,000,000 / \$ 77,000,000

<u>Category</u>	<u>Original</u>	<u>Current</u>
Construction	\$ 52,571,000	\$ 52,751,000
Professional	\$ 8,892,875	\$ 8,287,349
FF&E	\$ 5,907,300	\$ 6,002,530
Administrative	\$ 859,318	\$ 859,734
Contingency	\$ 5,490,148	\$ 5,659,418
Regents' Rules	\$ 3,279,359	\$ 3,439,969

Gross Square Feet: 150,000 GSF

Team / Status:

- Design Professional:
 Treanor Architects @ 3%
- Construction Manager at Risk (CMR):
 Flintco, LLC
- Construction Manager Agent (CMAgent):
 Project Control of Texas, Inc.
- Artist:
 TBD

Substantial Completion Date:

Original Date – January 2019
 Actual Date - TBD



TTU – 19th Street Improvement Initiative

TxDOT (~ \$3.0M)

- Overall Management
- Design / Bid
- Construction Management
 - Demolition
 - Concrete / Hardscape
 - Safety / Signal Upgrades
- Sidewalks / Shared Use Paths
- Medians

Texas Tech University (~ \$600K)

- Design of TTU Frontage
 - Shared Use Path
 - Benches
- Provide Soft Scape
 - Materials / Installation
 - 19th St Median (5 locations)
 - North Edge (TTU Frontage)
 - Continue Maintenance of TTU Frontage

City of Lubbock

- Approvals / Process for South Side of 19th Street Parking Change
- Long Term Maintenance of Landscaped Medians – Labor and Materials

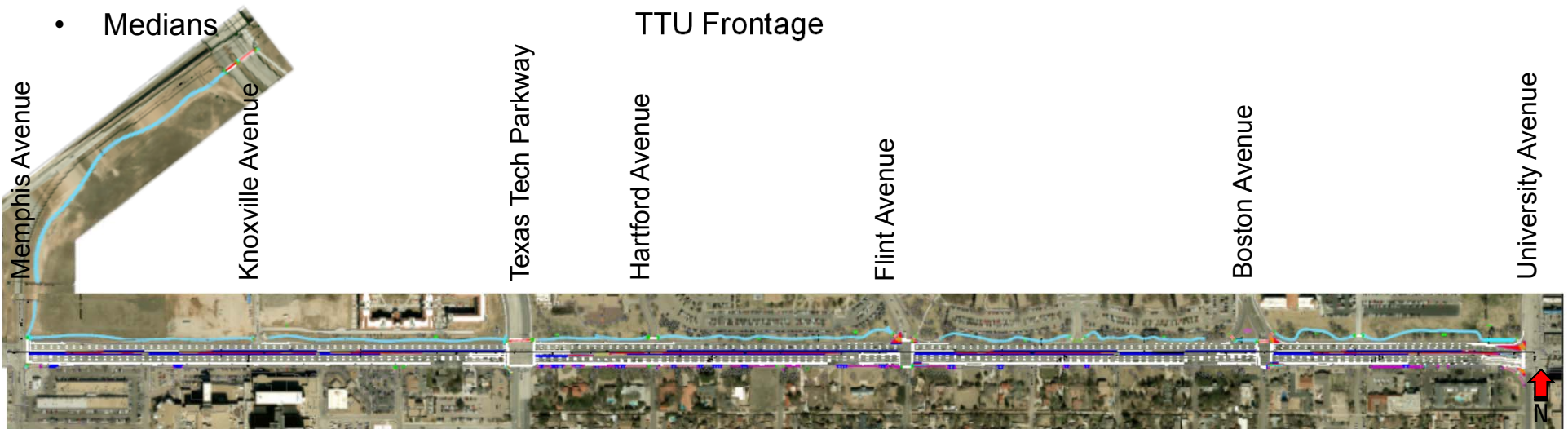

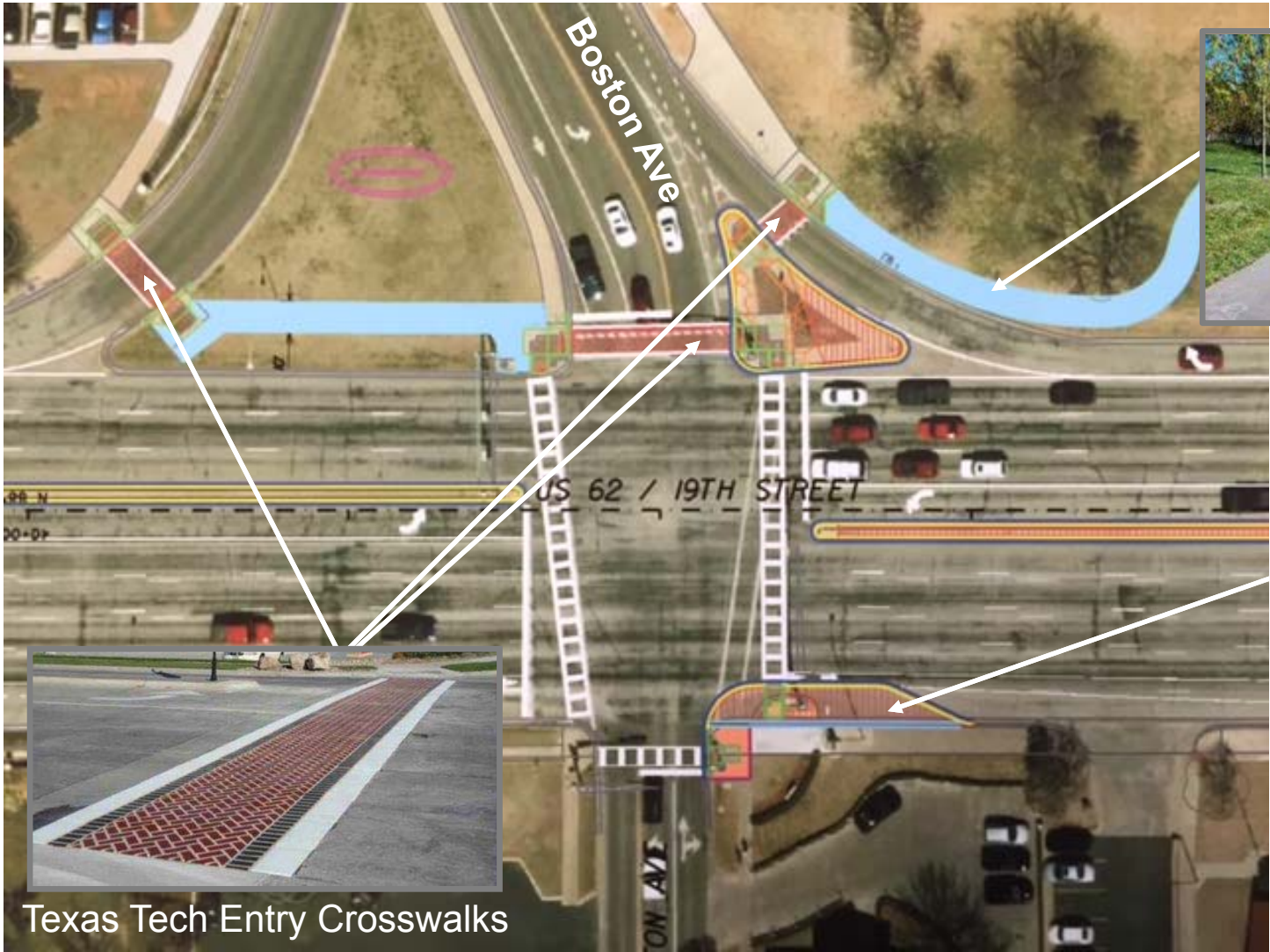

Shared Use Path



Texas Tech Entry Crosswalks

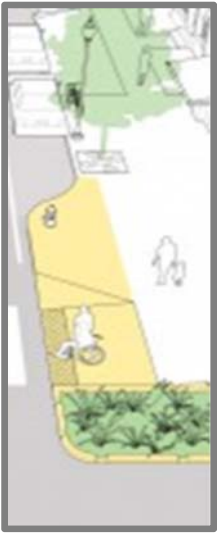

Curb Extension

Median Features



Feather Reed Grass



Redleaf Barberry



Blue Grama



Firework Fountain Grass

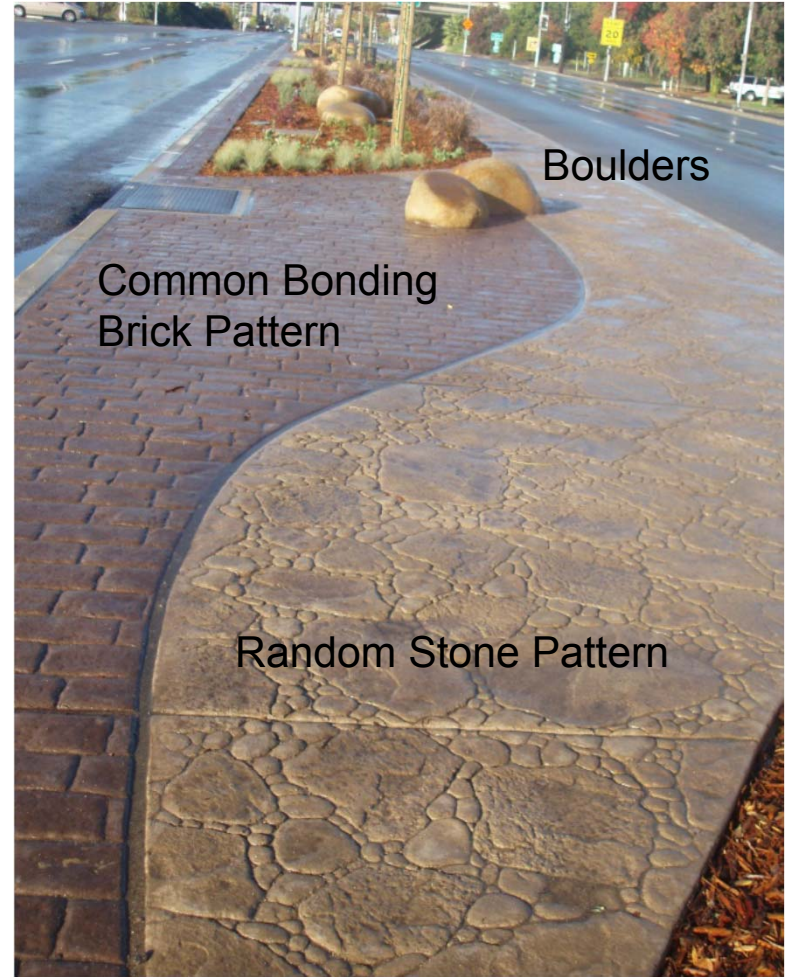

Boulders

Common Bonding
Brick Pattern

Random Stone Pattern

Proposed Project Schedule

TxDOT Bid Date

November 2016

Estimated Construction Start

Early Spring 2017

Construction Duration

5 to 6 Months

TTU – Maddox Engineering Research Center

Project Budget: Original / Current
 \$ 30,700,000 / \$ 29,207,030

Category	Original	Current
Construction	\$ 23,156,012	\$ 23,348,133
Professional	\$ 854,168	\$ 2,028,530
FF&E	\$ 3,157,222	\$ 2,095,864
Administrative	\$ 362,453	\$ 372,823
Contingency	\$ 462,492	\$ 107,821
Regents' Rules	\$ 1,214,683	\$ 1,253,859

Gross Square Feet: 79,039 GSF

Team / Status:

- Design Build Team:
 Western Builders of Amarillo, Inc. /
 Condray Design Group - Construction @ 91%
 - Construction Manager Agent (CMAgent):
 Waived by BOR 05-15-2015
 - Artist:
 Frank Swanson / Late August Installation
- Substantial Completion Date:
 Original Date – August 2016
 Actual Date - TBD

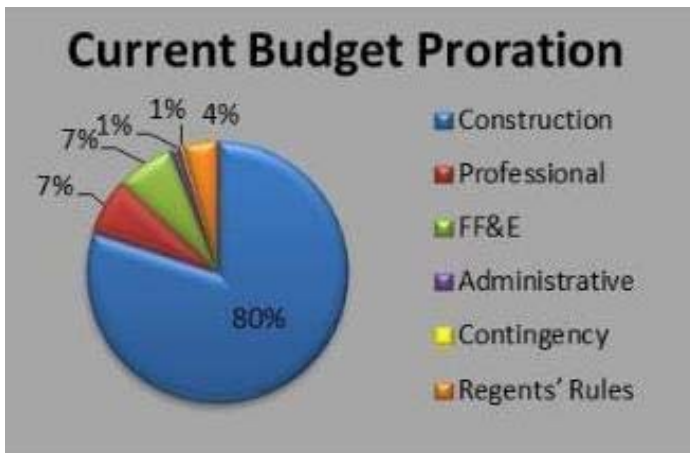

TTU – Industrial Engineering Building Renovation

Project Budget: Original / Current
 \$ 5,000,000 / \$ 9,859,000

Category	Original	Current
Construction	\$ 2,723,120	\$ 6,120,004
Professional	\$ 312,049	\$ 960,498
FF&E	\$ 1,508,731	\$ 2,350,147
Administrative	\$ 86,100	\$ 104,015
Contingency	\$ 370,000	\$ 243,278
Regents' Rules	\$ 0	\$ 81,058

Gross Square Feet: 40,872 GSF

Team / Status - Phase I:

- Design Professional:
 Dekker/Perich/Sabatini / CA @ 62%
- Construction Manager at Risk (CMR):
 Teinert Commercial Bldg Srvs/Const. @ 89%
- Construction Manager Agent (CMAgent):
 None Required
- Artist:
 Waived by BOR on 03-06-2015 – Phase I
 Artist Interviews in October 2016- Phase II

Substantial Completion Date:

Original Date – August 2016 – Phase I
 Actual Date - TBD

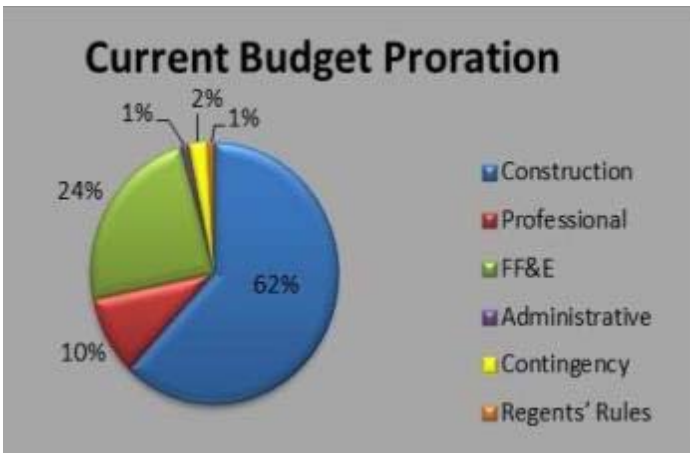

TTU – Rawls College of Business Admin. Addition

Project Budget: Original / Current
 \$ 15,000,000 / \$ 15,874,782

Category	Original	Current
Construction	\$10,452,000	\$ 12,096,802
Professional	\$ 1,185,680	\$ 1,184,044
FF&E	\$ 1,299,000	\$ 1,455,895
Administrative	\$ 56,523	\$ 106,346
Contingency	\$ 1,156,393	\$ 354,989
Regents' Rules	\$ 850,404	\$ 676,706

Gross Square Feet: 42,901 GSF

Team / Status:

- Design Professional:
 Parkhill, Smith & Cooper, Inc. / CA @ 95%
- Construction Manager at Risk (CMR):
 Lee Lewis Construction, Inc. / Const. @ 92%
- Construction Manager Agent (CMAgent):
 None Required
- Artist:
 Koryn Rolstad / August 2016 Installation

Substantial Completion Date:

Original Date – August 2016 /
 Chick fil A - November 2016
 Actual Date -

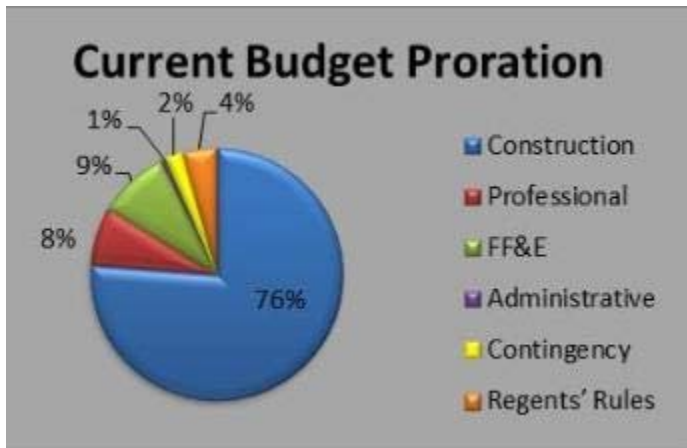

TTU – Jones AT&T Stadium NEZ Building Renovations

Project Budget: Original / Current
 \$ 3,750,000 / \$ 4,650,000

Category	Original	Current
Construction	\$ 2,404,500	\$ 4,002,397
Professional	\$ 309,662	\$ 284,895
FF&E	\$ 668,638	\$ 168,934
Administrative	\$ 67,200	\$ 35,200
Contingency	\$ 36,750	\$ 45,268
Regents' Rules	\$ 263,250	\$ 113,306

Gross Square Feet: 10,505 GSF

Team / Status:

- Design Professional:
MWM Architects, Inc. / Design @ 72%
- Construction Manager at Risk (CMR):
Teinert Commercial Bldg Svcs / Const. @ 73%
- Construction Manager Agent (CMAgent):
None Required
- Artist:
Tony Greer & Larry Simmons /
October 2016 Installation

Substantial Completion Date:

Original Date – July 2016
 Actual Date – September 2, 2016

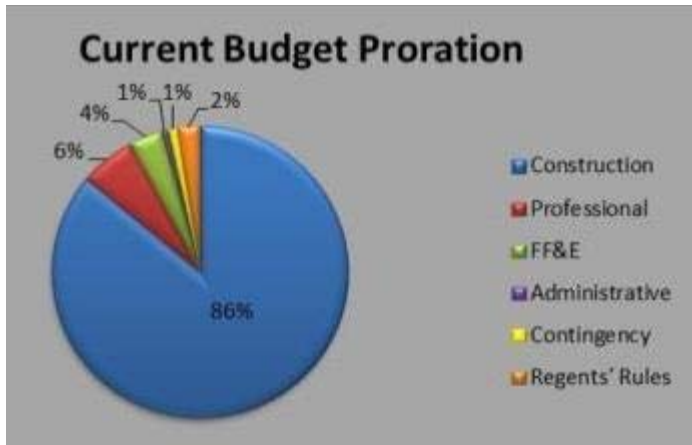

TTU – Sports Performance Center

Project Budget: Original / Current
 \$ 48,000,000 / \$ 48,000,000

Category	Original	Current
Construction	\$ 37,935,435	\$ 37,935,685
Professional	\$ 6,206,641	\$ 6,206,641
FF&E	\$ 1,278,943	\$ 1,278,943
Administrative	\$ 228,612	\$ 228,612
Contingency	\$ 279,251	\$ 279,001
Regents' Rules	\$ 2,071,118	\$ 2,071,118

Gross Square Feet: 156,245 GSF

Team / Status:

- Design Professional:
Gensler / Design @ 80%
- Construction Manager at Risk (CMR):
Flintco, LLC / Construction @ 17%
- Construction Manager Agent (CMAgent):
PC Sports, Inc. @ 40%
- Artist:
Selection in process

Substantial Completion Date:

Original Date – July 2017
 Actual Date - TBD

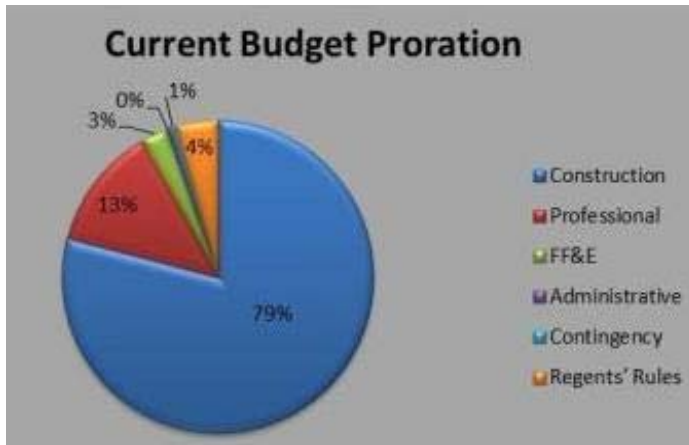

TTU – New Honors Residence Hall

Project Budget: Original / Current
 \$ 30,000,000 / \$ 29,900,000

Category	Original	Current
Construction	\$ 21,979,214	\$ 24,763,734
Professional	\$ 3,327,490	\$ 3,049,778
FF&E	\$ 2,931,813	\$ 365,500
Administrative	\$ 303,040	\$ 119,415
Contingency	\$ 180,840	\$ 277,573
Regents' Rules	\$ 1,277,603	\$ 1,324,000

Gross Square Feet: 81,532 GSF

Team / Status:

- Design-Build Team:
 Whiting-Turner / BGK Architects and Mackey
 Mitchell Architects / Construction @ 20%
- Construction Manager Agent (CMAgent):
 Parkhill, Smith & Cooper, Inc. @ 17%
- Artist:
 Marc Fornes/Thevermany Studio: Contract routing

Substantial Completion Date:

Original Date – July 15, 2017
 Actual Date - TBD

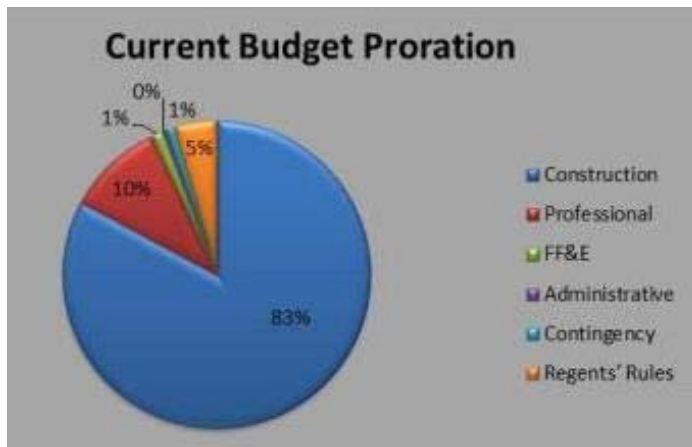

TTUHSC – Abilene Public Health Facility

Project Budget: Original / Current
 \$ 14,250,000 / \$ 15,000,000

Category	Original	Current
Construction	\$ 9,150,000	\$ 11,102,000
Professional	\$ 878,000	\$ 882,700
FF&E	\$ 3,055,500	\$ 2,266,500
Administrative	\$ 36,500	\$ 82,000
Contingency	\$ 664,480	\$ 161,100
Regents' Rules	\$ 465,520	\$ 505,700

Gross Square Feet: 43,803 GSF

Team / Status: Proposed Gift-in-Kind

- Design Professional:
Parkhill, Smith & Cooper, Inc. / CA @ 93%
- General Contractor (CSP):
Imperial Construction, Ltd. / Const. @ 93%
- Construction Manager Agent (CMAgent):
None Required
- Artist:
Mid-Ocean Studio / Sept. 2016 Installation

Substantial Completion Date:

Original Date – August 2016
 Actual Date - TBD

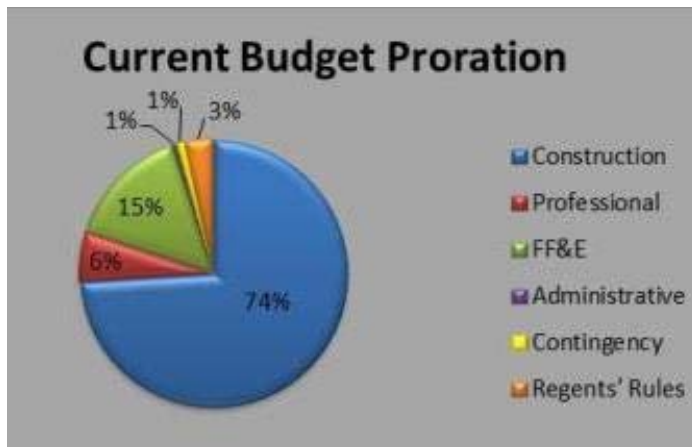

TTUHSC – Lubbock Education, Research & Technology + West Expansion

Project Budget: Original
\$83,700,000

Category	Original
Construction	\$ 60,254,000
Professional	\$ 9,438,710
FF&E	\$ 6,126,600
Administrative	\$ 792,125
Contingency	\$ 3,524,130
Regents' Rules	\$ 3,564,435

Gross Square Feet: ~ 200,000 GSF

Team / Status:

- Design Professional:
Perkins + Will @ 19%
- Construction Manager at Risk (CMR):
Hill & Wilkinson General Contractors @ 7%
- Construction Manager Agent (CMAgent):
Hill International
- Artist:
TBD

Substantial Completion Date:
Original Date – January 2019
Actual Date - TBD



TTUHSC – Amarillo Panhandle Clinical Simulation Center

Project Budget: Original / Current
 \$ 9,750,000 / \$ 9,750,000

<u>Category</u>	<u>Original</u>	<u>Current</u>
Construction	\$ 6,837,000	\$ 6,525,299
Professional	\$ 874,460	\$ 889,618
FF&E	\$ 1,247,940	\$ 1,899,300
Administrative	\$ 195,762	\$ 28,714
Contingency	\$ 403,648	\$ 210,344
Regents' Rules	\$ 191,190	\$ 196,725

Gross Square Feet: ~ 20,593 GSF

Team / Status:

- Design Professional:
Dekker/Perich/Sabatini @ 72%
- General Contractor:
Western Builders of Amarillo, Inc.
- Construction Manager Agent (CMAgent):
None Required
- Artist:
Selection in process

Substantial Completion Date:

Original Date – September 4, 2017
Actual Date - TBD



TTUHSC – Odessa Permian Basin Academic Facility

Project Budget: Original / Current
 \$ 19,800,000 / \$ 22,300,000

Category	Original	Current
Construction	\$ 14,183,840	\$ 16,541,032
Professional	\$ 2,046,490	\$ 2,322,063
FF&E	\$ 1,671,660	\$ 1,858,861
Administrative	\$ 231,792	\$ 58,900
Contingency	\$ 823,016	\$ 537,944
Regents' Rules	\$ 843,202	\$ 981,200

Gross Square Feet: 50,966 GSF

Team / Status:

- Design Professional:
 FKP Architects, Inc. @ 18%
- General Contractor
 Flintco, LLC
- Construction Manager Agent (CMAgent):
 Adams Management Services
- Artist:
 TBD

Substantial Completion Date:

Original Date – May 2018
 Actual Date - TBD

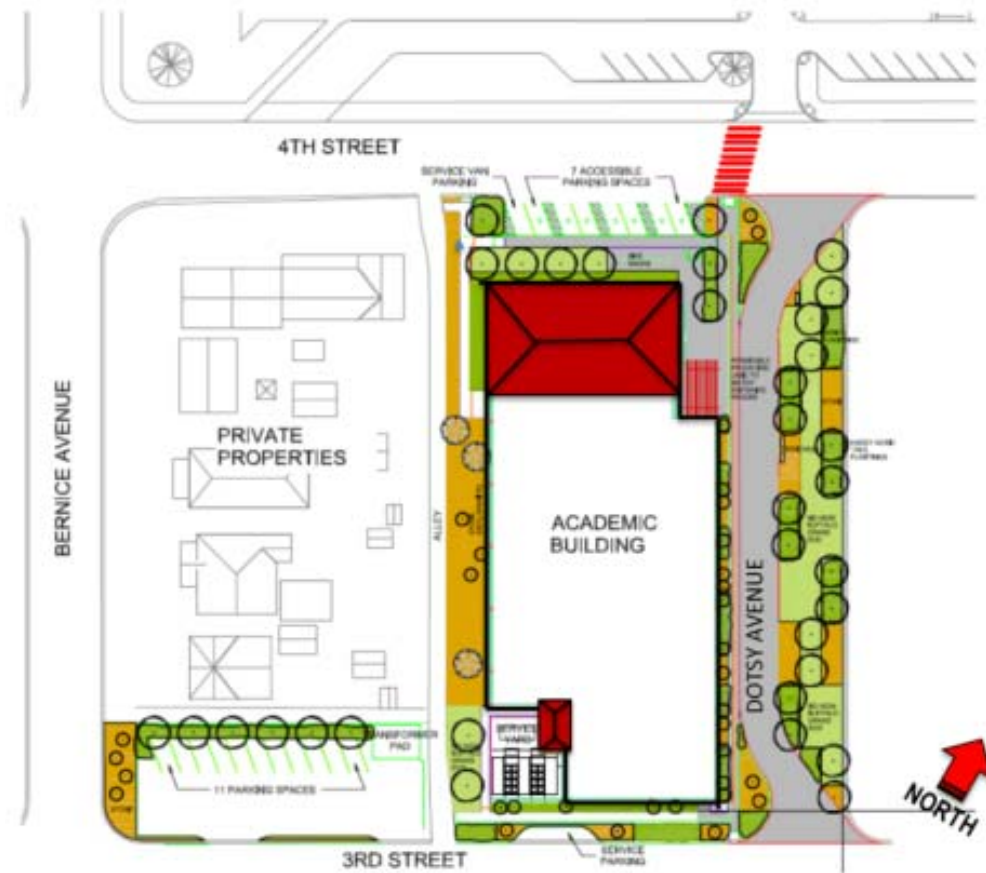

TTUHSC El Paso - Medical Sciences Building II

Project Budget: Original
\$ 84,400,000

<u>Category</u>	<u>Original</u>
Construction	\$ 59,398,160
Professional	\$ 9,749,196
FF&E	\$ 7,302,320
Administrative	\$ 856,129
Contingency	\$ 3,499,945
Regents' Rules	\$ 3,594,250

Gross Square Feet: ~ 227,000 GSF

Team / Status:

- Design Professional:
Perkins + Will @ 5%
- Construction Manager at Risk (CMR):
Sundt / Signed 9/21/2016
- Construction Manager Agent (CMAgent):
Broaddus and Associates @ 3%
- Artist:
TBD

Substantial Completion Date:
Original Date – December 2018
Actual Date - TBD



ASU LeGrand Football Stadium Press Box

Project Budget: Original / Current
 \$ 3,000,000 / \$ 3,500,000

Category	Original	Current
Construction	\$ 2,330,438	\$ 2,901,500
Professional	\$ 165,500	\$ 153,270
FF&E	\$ 84,500	\$ 247,800
Administrative	\$ 13,500	\$ 6,100
Contingency	\$ 346,062	\$ 121,330
Regents' Rules	\$ 60,000	\$ 70,000

Gross Square Feet: 6,660 GSF

Team / Status:

- Design Professional:
Gary Donaldson Architects
- Construction Manager at Risk (CMR):
Waldrup
- Construction Manager Agent (CMAgent):
None Required
- Artist:
TBD

Substantial Completion Date:

Original Date – August 2017
 Actual Date - TBD

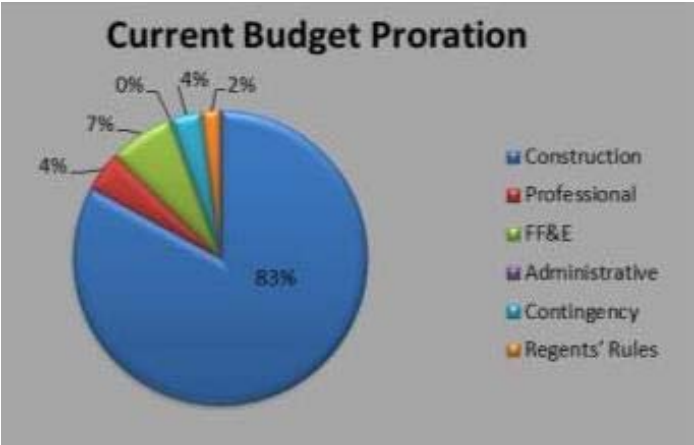

ASU Hunter Strain Engineering Laboratories Addition

Project Budget: Original / Current
 \$ 4,000,000 / \$ 4,000,000

<u>Category</u>	<u>Original</u>	<u>Current</u>
Construction	\$ 2,908,500	\$ 2,868,800
Professional	\$ 314,366	\$ 374,250
FF&E	\$ 462,500	\$ 387,400
Administrative	\$ 19,650	\$ 8,000
Contingency	\$ 214,984	\$ 283,128
Regents' Rules	\$ 80,000	\$ 78,422

Gross Square Feet: 9,000 GSF

Team / Status:

- Design Professional:
Kinney Franke Architects, Inc. @ 58%
- Construction Manager at Risk (CMR):
Western Builders of Amarillo
- Construction Manager Agent (CMAgent):
None Req'd
- Artist:
TBD

Substantial Completion Date:

Original Date – April 2017
 Actual Date - TBD



ASU Archer College of Health and Human Services

Project Budget: Original / Current
 \$ 26,360,000 \$ 26,360,000

<u>Category</u>	<u>Original</u>	<u>/</u>	<u>Current</u>
Construction	\$ 18,057,480		\$ 13,495,000
Professional	\$ 3,034,827		\$ 2,798,640
FF&E	\$ 2,785,243		\$ 2,825,243
Administrative	\$ 290,737		\$ 140,395
Contingency	\$ 1,069,152		\$ 5,940,882
Regents' Rules	\$ 1,122,561		\$ 1,159,840

Gross Square Feet: 56,600 GSF

Team / Status:

- Design Professional:
PBK Architects @55%
- Construction Manager at Risk (CMR):
Western Builders of Amarillo @ 1%
- Construction Manager Agent (CMAgent):
Hill International @ 10%
- Artist:
TBD

Substantial Completion Date:

Original Date – December 2017
Actual Date - TBD



TTUSA – System Office Building

Project Budget: Original / Current
 \$ 27,500,000 / \$ 27,500,000

Category	Original	Current
Construction	\$ 20,785,789	\$ 21,317,658
Professional	\$ 2,228,761	\$ 2,298,842
FF&E	\$ 2,219,000	\$ 2,269,200
Administrative	\$ 321,450	\$ 169,712
Contingency	\$ 542,000	\$ 234,588
Regents' Rules	\$ 1,403,000	\$ 1,210,000

Gross Square Feet: 76,722 GSF

Team / Status:

- Design Professional:
 Parkhill, Smith & Cooper, Inc. / Design @ 82%
- Construction Manager at Risk (CMR):
 J T Vaughn Construction, LLC/Construction @ 60%
- Construction Manager Agent (CMAgent):
 Waived
- Artist:
 Bruce Munro / February 2017 Installation

Substantial Completion Date:

Original Date – March 2017
 Actual Date - TBD

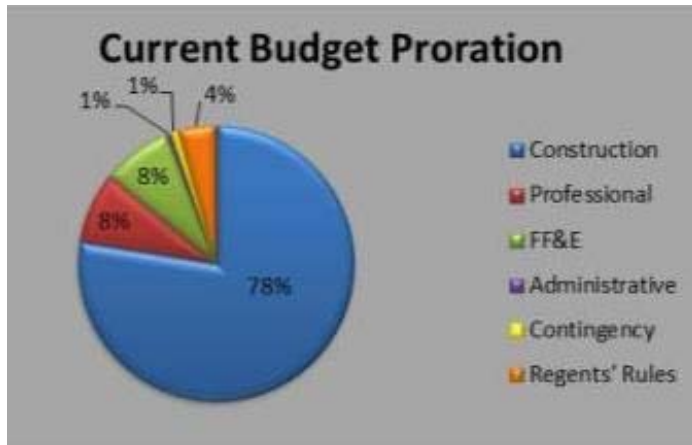

Texas Tech University System

Item 4

Status of Public Art

Michael S. Molina



TTU – Rawls College of Business Addition

Art Budget: \$ 142,000

Artist: Koryn Rolstad
Seattle, WA

Title: "Illuminated Arboreal Data Codes"

Status: Installed August 2016



TTU – Rawls College of Business Addition

Art Budget: \$ Donation

Artist: Glenna Goodacre
Santa Fe, NM

Title: "CEO"

Status: Installed August 2016



TTU – Maddox Engineering Research Center

Art Budget: \$ 243,000

Artist: Frank Swanson
Littleton, CO

Title: "Mechanism"

Status: Installed August 2016



TTU – Art 3-D Annex

Art Budget: \$ 38,000

Artist: Jon Whitfill
Lubbock, TX

Title: "Syntaxis Mathematica"

Status: Installed August 2016



TTU – Jones AT&T Stadium North End Zone Building Renovation

Art Budget: \$ 32,000

Artist: Tony Greer & Larry Simmons
Lubbock, TX

Title: Awaiting artist announcement

Status: October 2016 Installation



TTU – New Honors Residence Hall

Art Budget: \$ 287,000

Artist: Marc Fornes / Theverymany
New York, NY

Title: Wandering

Status: TBD

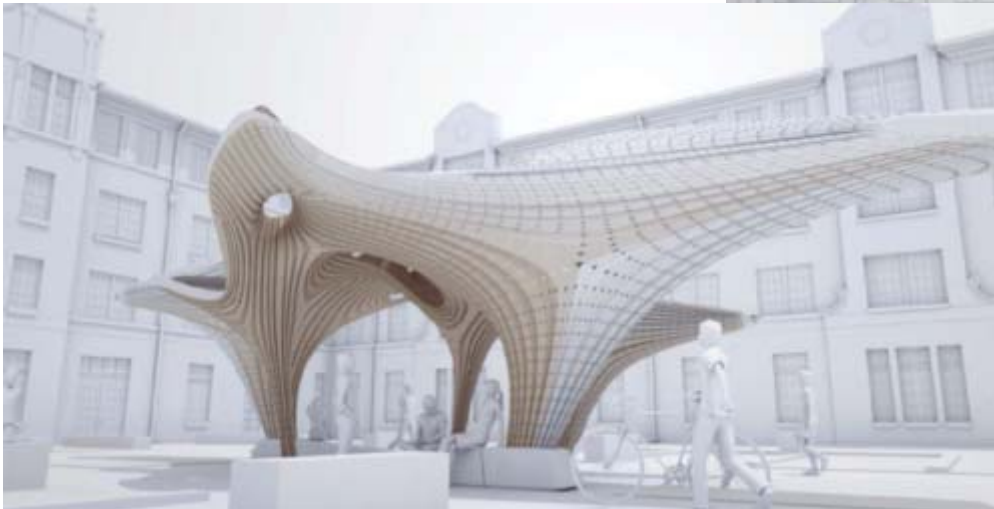
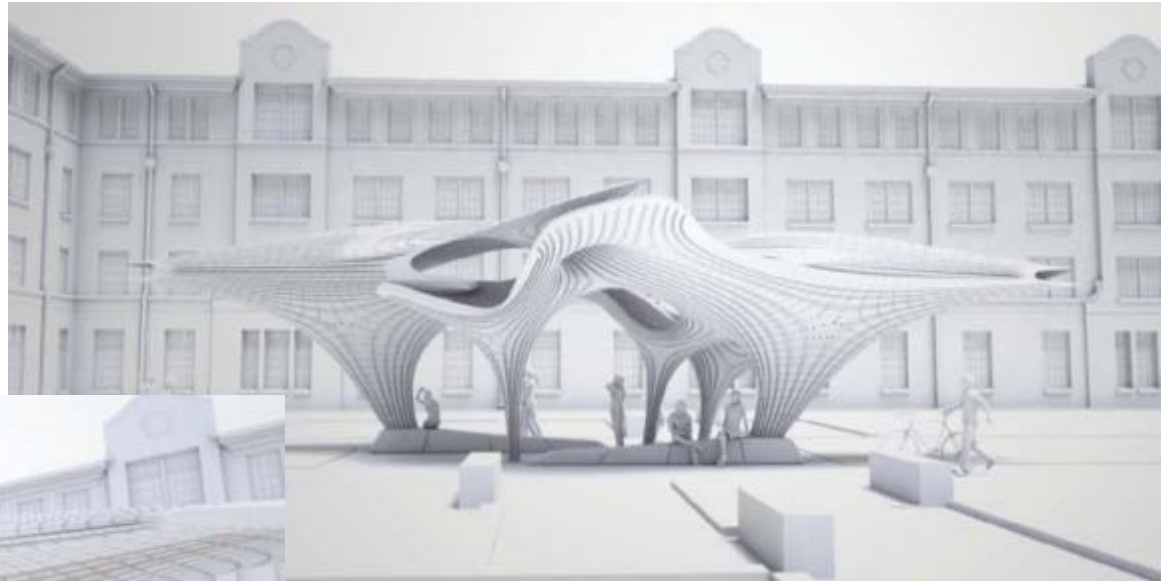

TTUHSC – Abilene School of Public Health

Art Budget: \$ 142,000

Artist: Mid-Ocean Studio
Providence, RI

Title: "The Convergence of Healing Forces"

Status: Installed September 2016



TTUS – System Office Building

Art Budget: \$ 265,000

Artist: Bruce Munro
Wilshire, England

Title: Awaiting artist announcement

Status: February 2017 Installation

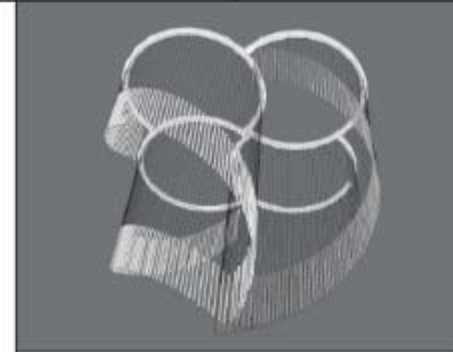
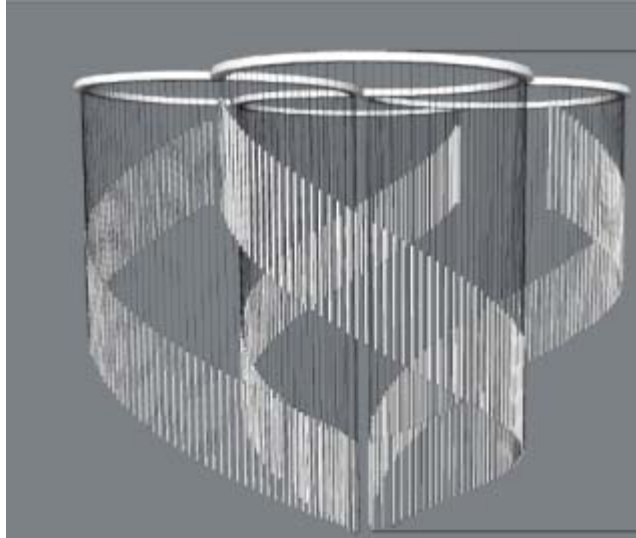
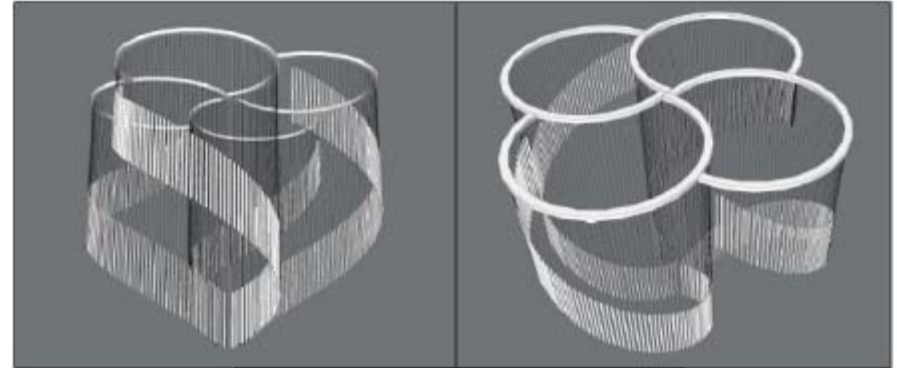



TEXAS TECH UNIVERSITY SYSTEM™